



WOOD BOILER DUET



SWEDISH MADE



**WOOD AND PELLETS/
WOOD CHIPS BOILER**

V202KUB/Duet

Extuna V202 K UB

Ceramic wood boiler with extra furnace for pellets, wood chips or oil

Our popular ceramic boiler for half-meter firewood firing is prepared for connection of an additional permanently mounted fuel firing, for pellets, wood chips or oil.

(With preset settings, you can easily switch between the fuel options and maintaining optimal heating effect.

Despite the great advantage is additional furnace, the length of the boiler increases only 37 cm, compared with our ceramic boiler V202K UB.)

When customer orders our product, they are able to specify which orientation of pellets or wood chips shall be connected, so that we can get correct measurement of the frame assembling.



The picture shows our standard model boiler. Connections can be designed and set up according to customers' requirement when ordering.

Technical Data

Model	Width	Lenght	Height	Bottom to flue height
35	540 mm	1420 mm	1135 mm	870 mm
55	660 mm	1420 mm	1280 mm	1010 mm
70	660 mm	1420 mm	1420 mm	1150 mm

Model 70 requires chimney fan.

Standard Equipment

- * Draught gauge
- * Flue temperature measurement
- * Flue temperature measurement
- * Sweeping tools
- * Flue funnel
- * Turbulator
- * Overheating protection
- * Instruction

Model	Wood	Effect Wood chips	Pellets	Wood Capacity	Water volume	Recommended accumulator volume	Chimney draught	Weight
35	35 kW	40 kW	20 kW	125 L	210 L	800-2300 L	25 PA	625 Kg
55	55 kW	60 kW	40 kW	180 L	270 L	2000-5000 L	30 PA	665 Kg
70	70 kW	80 kW	60 kW	230 L	320 L	4000-6000 L	40 PA	700 Kg

Extuna manufactures custom-made accumulator tanks according to our customer's specifications.
All Extuna boliers are made in 5 mm plate.

Extuna has its own production of ceramics

Extuna has its own production of ceramics to obtain full control of all the important elements which are required to produce a product with high strength and long service life. The Ceramic in V 202 K UB is very easy to change.



Exploded view of boiler

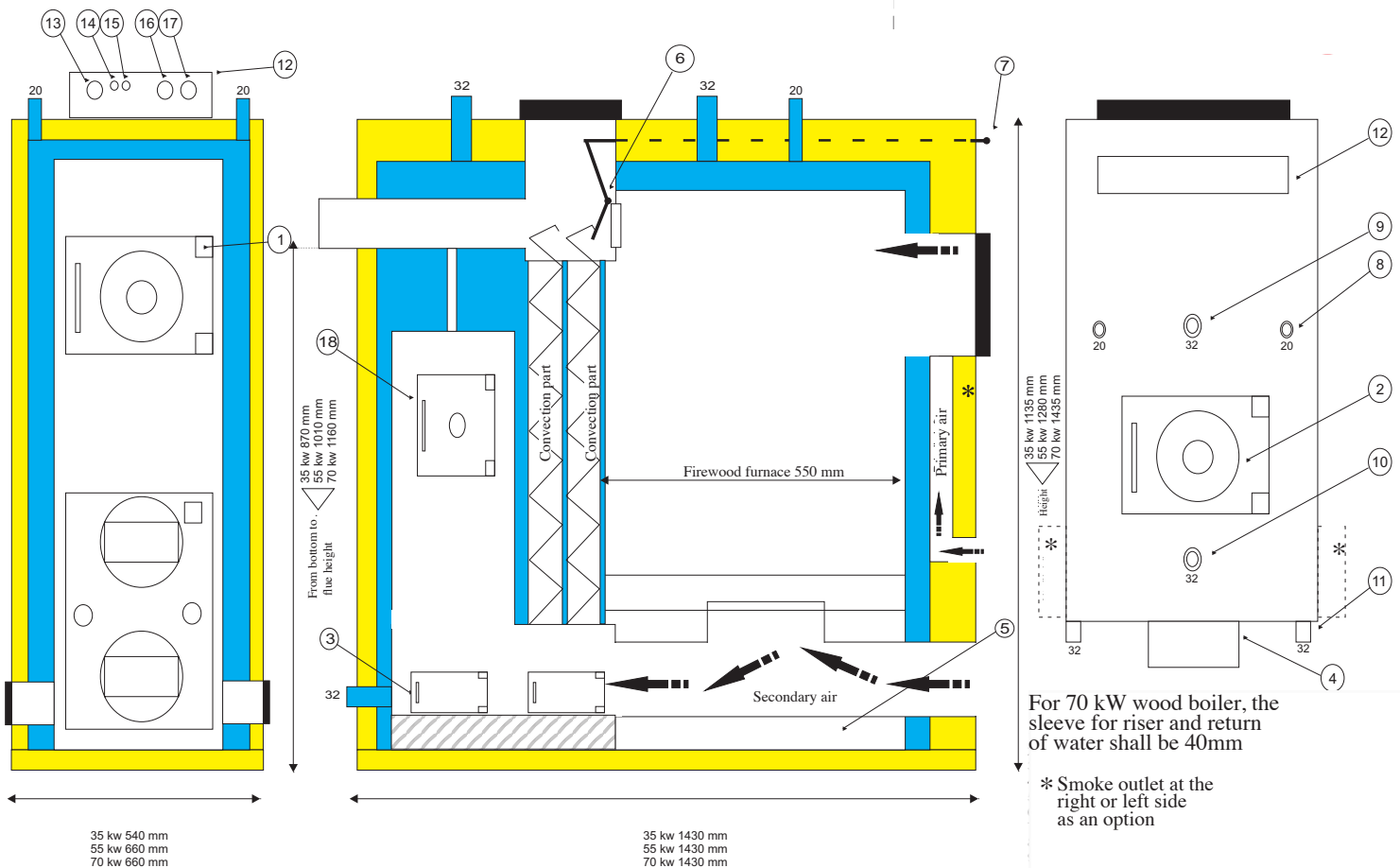

- | | | |
|----------------------------|------------------------|----------------------------------|
| 1 Firewood door | 7 Damper shaft | 13 Temperature stop controllor |
| 2 Ash door | 8 Temperature limiter | 14 Start button |
| 3 Ash door | 9 Riser and expansion | 15 Operation indicator light |
| 4 Flue funnel 140 x 220 mm | 10 Riser and expansion | 16 Pressure and temp.measurement |
| 5 Ceramic | 11 Return | 17 Flue gas thermometer |
| 6 Damper | 12 Control panel | 18 Door of burner |

Extuna has more than 40 years' experience in manufacturing boilers and accumulator tanks by professionals with a wealth of knowledge



EXTUNA AB was founded in 1964 in Borlänge, Sweden and manufactured and produced oil burners from the beginning. Boiler manufacturing began 1971, and since 1986 EXTUNA started specialized production in boilers and accumulator tanks instead of oil burners. After 1980 EXTUNA production moved to our own modern premises in Ingarvets industrial estate in Falun. The unique ceramic wood boiler is our flagship product which was first tested and approved by SP Technical Research Institute of Sweden in 1984.

Here you can find us in Falun



EXTUNA Products can meet different needs of customers

Wood-Ceramic



**Ceramic Duet-2 Furnace
Wood-Pellet-Wood Chip**



Wood Chip

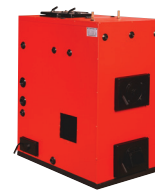

Pellet-Wood



**Double-Boiler
Pellet-Wood**



Accumulator tank



Kitchen-Boiler



EXTUNA PRODUKTION AB

Zettergrensväg 16
791 77 FALUN
Tel. 023-26990
Mob. 070-642 33 36

info@extuna.se
facebook.com/extuna
extuna.mobipage.se

Retailer

www.extuna.se